



Purple Line Prime Contractor Meetings

February 16, 2021 10:00 AM

February 23, 2021 3:00 PM

*IndyGo*_{SM}

Agenda

- Introductions
- Fast Facts About the Purple Line
- Purple Line Route
- Project Cost, Bid Packages and Schedule
- About Bid Packages A and B
- Funding Sources and Project Goals
- Invitation to Bid Process
- What Comes Next
- How We Are Helping to Connect Bidders with Subs
- After the Purple Line BRT, the Blue Line!

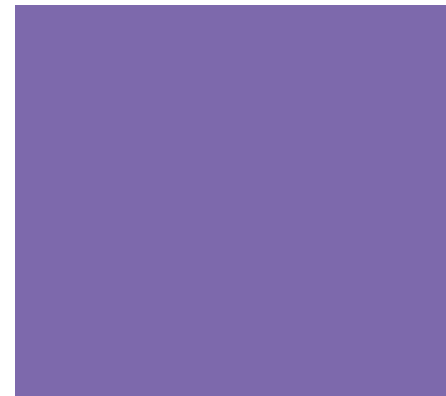

Purple Line Team Members

Jennifer Pyrz	IndyGo	Chief Development Officer and VP of Infrastructure, Strategy, and Innovation
Michael Booth	IndyGo	Capital Projects Director, Purple Line Project Manager
Rachel Wilson	IndyGo	Purple Line Deputy Project Manager
Matthew Duffy	IndyGo	Project Engineer
Tom Spragg	IndyGo	Construction Project Manager
Dave Adamson	IndyGo	Contract Specialist
Chelci Hunter	IndyGo	DBELO and Diversity Officer
Kevin McDuffie	IndyGo	Supplier Diversity Specialist
Gary Pohl	BF&S	Construction Management Team, Project Manager
Brad King	BF&S	Construction Management Team, Deputy Project Manager

Purple Line Team Members Cont.

Jennifer Bruner	IndyGo	Legal
Stacey Metz	IndyGo	Director of Procurement
Lesley Gordon	IndyGo	Director of Public Affairs and Partnerships
Faith Chadwick	IndyGo	Public Information Officer (PIO)
Jordan Patterson	IndyGo	Engagement Specialist

Although the members listed on this slide are not presenting information today, they still play a crucial role within the Purple Line Construction Project.



**We Need
Your Input!**

Poll Time!

Entities Involved in the Development of the Purple Line

- IndyGo
- Federal Transit Administration (FTA)
- Butler Fairman & Seufert (BF&S)
- WSP, USA
- Indianapolis Department of Public Works (DPW)
- Citizens Energy Group (CEG)
- City of Lawrence



UPDATED 07/07/2020

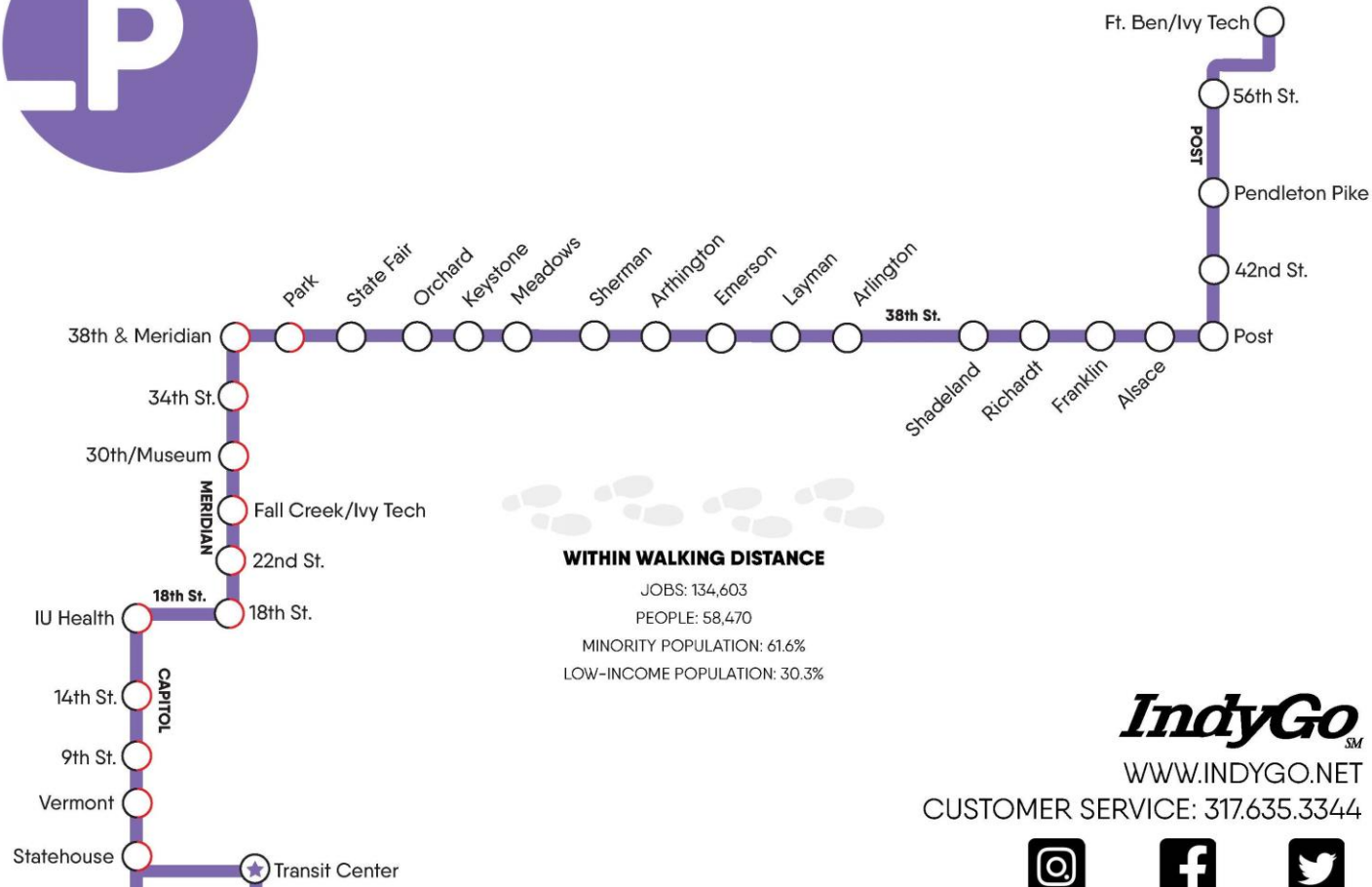

The Route:

- 15.2 Miles Long
- 30 Total Stations:
 - 18 stations will be exclusively for the Purple Line.
 - 12 stations will be shared with the Red Line.
- 90% Dedicated Lanes

IndyGoSM

WWW.INDYGO.NET

CUSTOMER SERVICE: 317.635.3344



Lane Configuration Overview

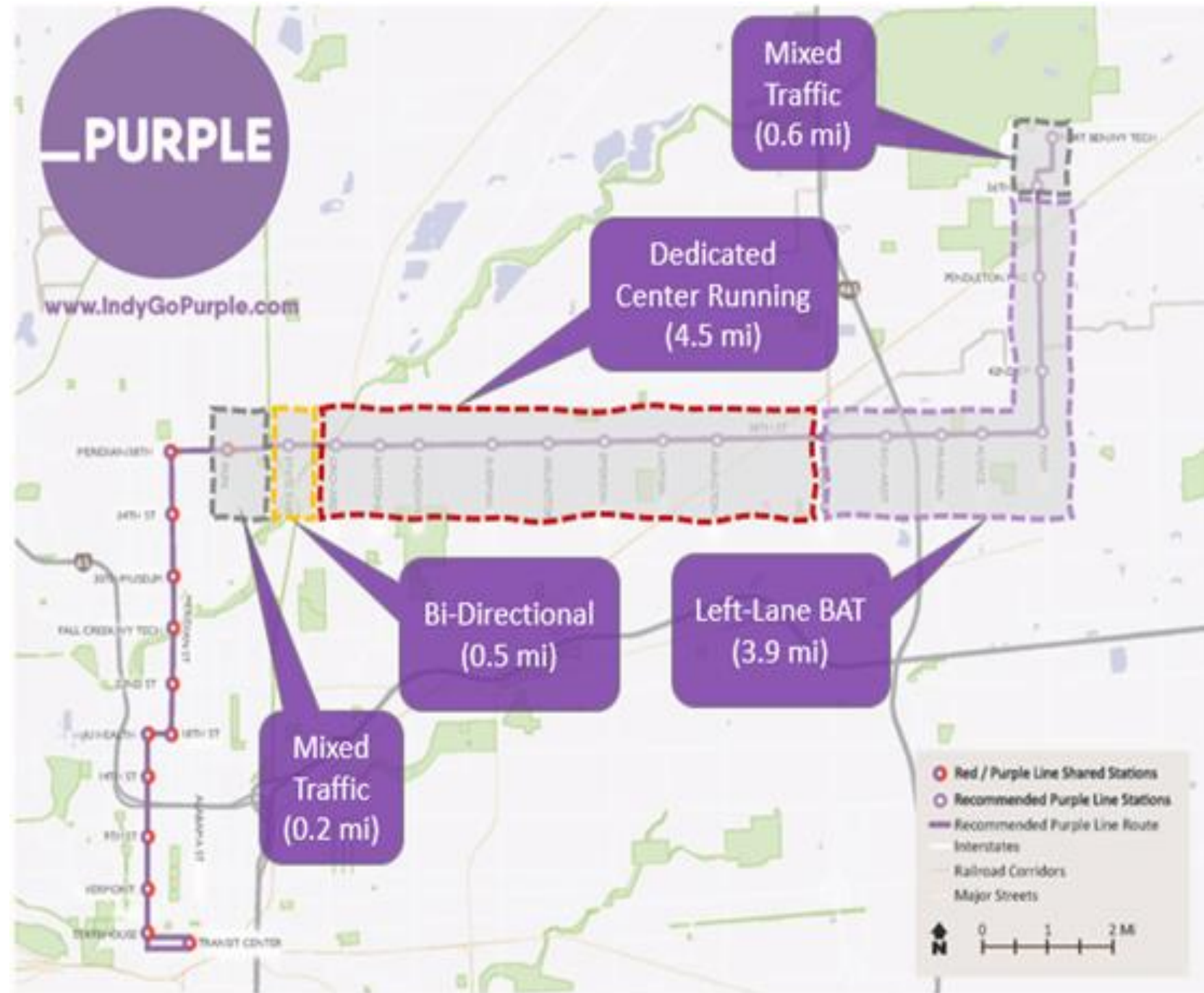

Station Overview

- 18 New Center Stations
- ~ ½ Mile Spacing
- At Signalized Intersections
- Raised Platform for Level Boarding
- Canopy Roof
- ADA Accessible
- Safe and Secure





38th & Richardt Station



38th &
Richardt
Night View





Lawrence Terminus Station



Lawrence Terminus Station

Project Cost, Bid Packages, and Schedule

Overall Project Budget: \$169.4 Million

Estimated Construction Cost: \$80-100 Million

Procurement Method: Design-Bid-Build with three (3) Bid Packages

- Package A: Road Work
- Package B: Stations
- Package A + Package B

Estimated Letting Date: Spring 2021-Summer 2021

Estimated Construction Start: Summer 2021

Estimated Calendar Years of Construction: 2021, 2022, 2023

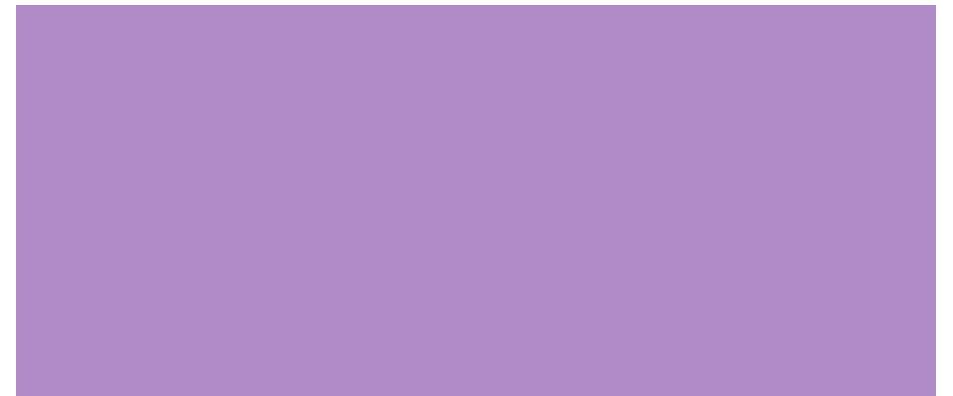



In Advance of Construction

To ensure a successful summer construction start, and in conjunction with our partners, we are preparing the project as follows:

1. Project will not be advertised until Federal grant is executed.
2. Utility relocations are underway.
3. E-Builder is setup for document submittals.
4. Stakeholder outreach is on-going.



About Bid Package A

Road Work:

- Dedicated Lanes
- Median and Raised Curbs
- Curb and Gutters
- Sidewalks and Paths
- Drainage Improvements
- Roadway Construction
- Patching and Resurfacing
- Pavement Markings
- Traffic Signals
- Signage

DBE Goal: 11%

Bid Package A – Civil and Utility Infrastructure

Trade Work Included in Package A – Civil and Utility Infrastructure Package Work

- Right of Way Clearing/Site Demolition
- Erosion Control
- Storm Drainage (Pipes, Manholes, Inlets, and Detention Ponds)
- Asphalt Paving (Full Depth, Patch, Mill and Resurfacing)
- Concrete (Patching, Curbs, Gutters, Sidewalks and Curb Ramps)
- Pavement Markings
- Maintenance of Traffic During Construction (Signs, Barricades, Pavement Markings, and Signals)
- Tree Protection
- Protection of Public Service Structure
- Retaining Walls (Concrete and Reinforcing Steel)
- Traffic Control Devices (Signals, Pedestrian)
- Signage
- Landscaping

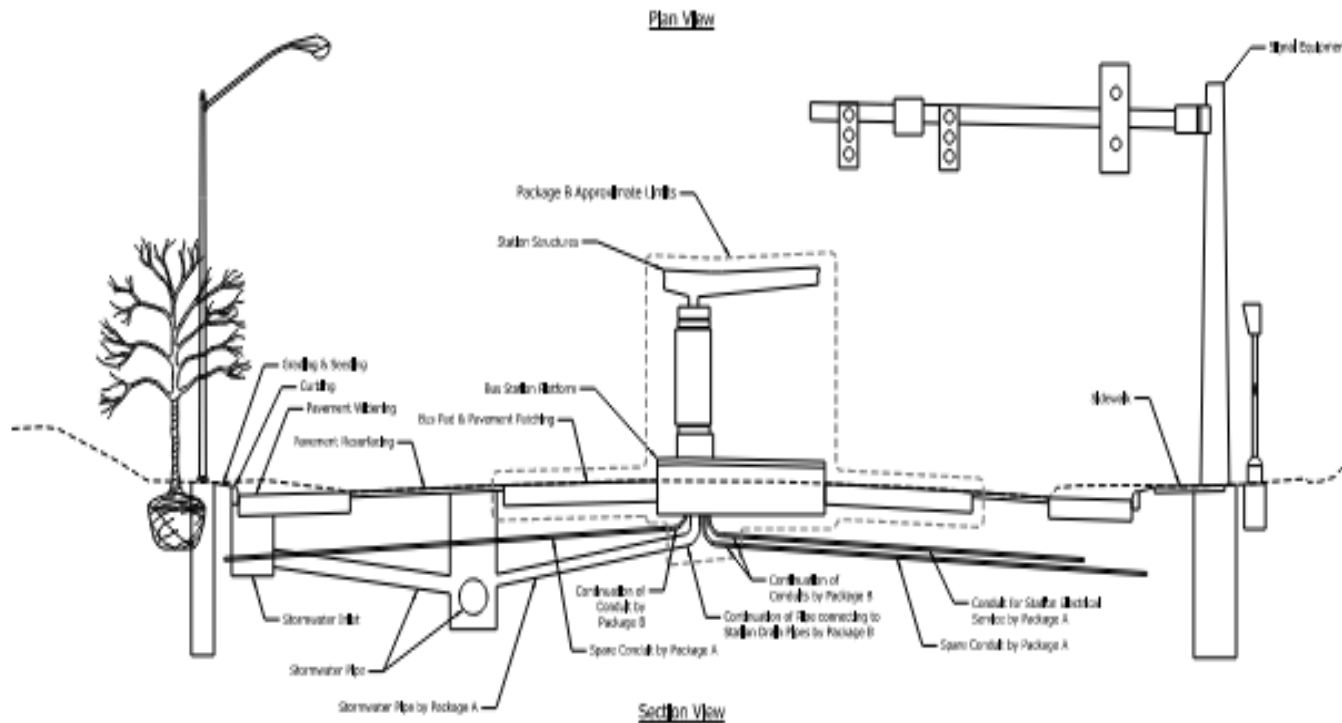

About Bid Package B

Stations:

- Canopy Roof
- Bus Pads
- Station Platforms
- Pedestrian Ramps
- Lighting
- Real Time Arrival Information
- Security
- Windscreens

DBE Goal: 5%



Bid Package B – Station and Communication

Trade work included in Package B – Stations and Communication

- Earthwork
- Maintenance of Traffic
- Structures
- Structural Steel, Cold Rolled Framing, Rough Carpentry, Finish Carpentry, Roofing, Joint Sealants, Doors and Hardware, Glass and Glazing, Finish Coatings, Piping and Tube Railings, Specialty Installation
- Plumbing
- Mechanical
- Electrical
- Communications
 - Communications Network
 - CCTV
 - Emergency Phone
 - Ticket Vending
 - Passenger Information Sign Systems
 - Public Address System

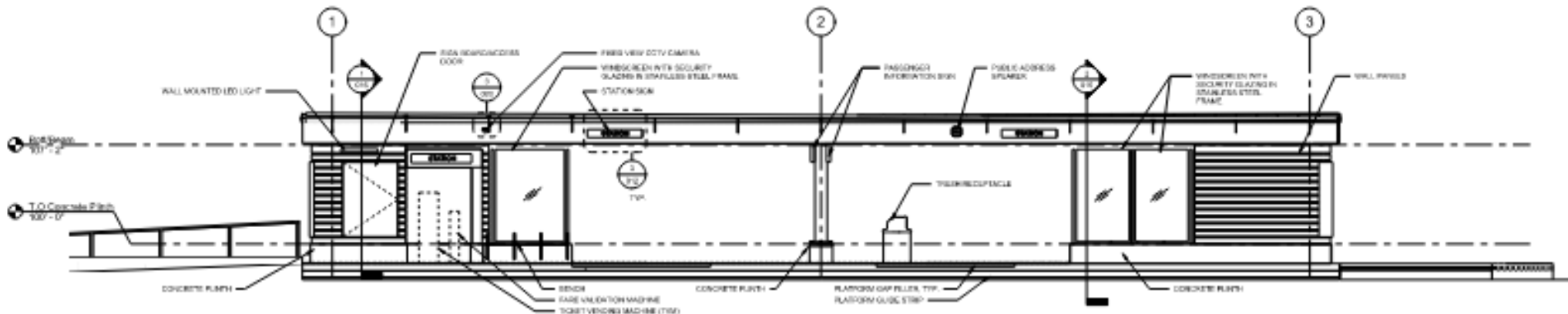

Changes from Red Line



Notable changes made as a result of Red Line "Lessons Learned" include:

1. Reduced coordination points between Package A and Package B contractors.
 - For example, Package B will construct the bus pads.
 - Milestones for handoff points between Packages.
2. Modified some station elements that were especially labor/time-intensive including wood cladding and handrails.
3. Conducted advanced Subsurface Utility Engineering (SUE) during design.
4. Maintenance of Traffic (MOT) phases for full closure of some intersections, and for some directional traffic.

Additional Requirements

- Project Schedule
- E-Builder Web Based Project Management System
- Station Platform Tolerance
- Sensitivity to Stakeholders and Neighbors
- Owner Procured Items

Owner Procured Items



Several pieces of equipment will be furnished by the Owner for installation by Contractors for Package A and B. Some examples:

- Transit Signal Priority (TSP) (A)
- Cellular Modems and Antennas (B)
- Ticket Vending and Validation (B)
- Public Address Speakers and Amplifiers (B)
- CCTV Cameras (B)
- Passenger Information Signs and Accessories (B)



- 15.2 MILES LONG
- CONNECTING INDIANAPOLIS TO LAWRENCE
- 18 PURPLE LINE-EXCLUSIVE STATIONS
- 12 SHARED RED LINE STATIONS



The Purple Line will be the second Bus Rapid Transit (BRT) line in Indiana. The 15.2-mile corridor will serve the Indianapolis Regional Center, extending north to 38th Street and northeast to the City of Lawrence. 5.4 Miles and 12 stations are shared with the Red Line BRT.

The Purple Line Construction Project will upgrade 9.8 miles of 38th Street, Post Road, Otis Avenue and Wheeler Road. To allow for operation of the BRT, 18 new Center Stations will be constructed including the Terminus Station in the City of Lawrence.

Estimated Construction Cost:
\$80 - \$100 Million

DBE Goal Range:
TBD

Estimated Letting Date:
Spring 2021 - Summer 2021

Estimated Calendar Years of Construction:
2021, 2022, 2023

Procurement Method:

Design-Bid-Build with three Bid Packages: Package A - Roadway, Package B - Stations, and Package A+B.

Estimated Quantities

51,700

LINEAR FEET OF STORM SEWER



1182

MANHOLES & INLETS



361

NUMBER OF NEW CURB RAMPS



91,245

LINEAR FEET OF CURB OR GUTTER



25

NEW OR UPGRADED TRAFFIC SIGNALS



9

MILES OF SIDEWALK & TRAIL



114,000

TONS OF HMA PAVEMENT



SPECIFIC FACTS

Replacement or Reconstruction of 9.8 miles of urban roadway including drainage & sidewalks

New signing, lighting, signals, ADA ramps and pavement markings

18 new ADA-accessible stations with signage, communications, security, and snow melt system

Fast Facts

Bid Packages



Bid Package Format:

- Bid Package A – Civil and Utility Infrastructure.
- Bid Package B – Stations and Communication.
- Bid Package A and B Combination.
 - Bidders who bid the combination are also encouraged to provide individual bid package bids.

Funding Sources & Project Goals

A portion of the funding for the Purple Line Construction project will come from the “Small Starts Grant.” The grant is federal money.

Both bid packages have their own DBE goals:

Package A = 11%

Package B = 5%

Read the requirements for participation closely.

Per FTA regulations IndyGo cannot set any State or Local “XBE” goals on federally funded projects. However, we will record all XBE participation.



Federal Transit Administration's Buy America

IndyGo's FTA Requirements

- FTA's Buy America regulations are applicable to this project.
- FTA's "Buy Americaa" regulations are **different** and **stricter** than the Federal Highway Administration's "Buy Americanan" regulations.
- Applies to iron, steel, and manufactured products.
- The design team has taken care to comply with Buy America requirements in the specification of products.

Invitation to Bid Process



IndyGo awards contracts in accordance with IC 36-1-12 and evaluates DBE utilization as a matter of responsiveness, pursuant to 49 CFR Part 26.

A Word About Wages

Prevailing Wage

- A prevailing wage is defined as the hourly wage, usual benefits and overtime, paid to workers, laborers, and mechanics within a particular area. This wage is usually the union wage.
- Prevailing wages are established by regulatory agencies for each trade and occupation employed in the performance of public work, as well as by the Department of Labor.

Davis-Bacon Act

- The Davis-Bacon Act is applicable to this project.
- Contractors and subcontractors must pay their laborers and mechanics no less than the locally prevailing wages.
- Applicable wage rates will be included in the solicitation.

Prime Contractor Prequalification Processes

Package A – Civil and Utility Infrastructure

- Contractor must be qualified by INDOT.

Package B – Stations and Communications

- Contractor must be qualified by IDOA.

Contractors bidding a **Combined Package A and Package B** do not need to be prequalified by both INDOT and IDOA.

- They need to be prequalified by *one or the other* and have the capacity to cover both packages. There are only certain codes that are applicable that will be accepted.





Bid Package A
Prime
Contractor
Prequalification

INDOT Process:

- Applies to work on Package A – Civil & Utility Infrastructure.
- Contractors that want to work as a prime contractor on a local public works project must be qualified by INDOT pursuant to IC 8-23-10-0.5.
- Subcontractors must also meet the applicable qualification requirements.

Bid Package A (Continued)

- INDOT has 30 days to act on an application.
- If you have any questions regarding the changes to the application, please contact the Prequalification Division at 317-232-5094.
- A fillable PDF of the application and further information can be gathered from the INDOT web site: <http://www.in.gov/indot/2740.htm>

Bid Package B
Prime
Contractor
Prequalification

IDOA Process:

- Applies to work on Package B – Stations and Communications.
- **Local Unit Public Work Projects** - Contractors must be pre-qualified with the Indiana Public Works Certification Board prior to starting work on any local public works project estimated to be over three hundred thousand dollars (\$300,000).
- Suppliers, as defined by IC 4-13.6-1-20, are not required to be qualified.



Bid Package B (Continued)

Pre-qualification information and applications can be found at the following link:

- https://www.in.gov/idoa/files/CONTRACTOR_APPLICATION_w-attachAandB-Nov-2015.pdf

The Department of Administration, Public Works Division, maintains a list of contractors and designers who are qualified to work on public works projects. They can be and can be found here:

- http://www.in.gov/idoa/files/certified_contractor_list.pdf

Likely Required Qualification Codes for Prime Contractors

Package A

- A (a) Concrete Pavement – General
- C (b) Light Grading
- E (h) Deep Sewer and/or Excavation
- E (b) Placing Asphalt Pavement

Note: Subcontractors must be qualified in the trade for which they will be utilized.

Package B

- Structural Steel Erection – 179.01
- Institutional and Commercial – 1542.00B

Note: Subcontractors must be qualified in the trade for which they will be utilized.

The logo for IndyGo, featuring the word "IndyGo" in a blue, stylized, italicized font. The text is centered within a white circle that has a purple, textured border. The background of the slide is white with a faint, light purple circular pattern.

IndyGo Responsible Bidder Policy

- Ensures only responsible and qualified contractors and subcontractors are awarded IndyGo construction projects (complements qualifications statutes).
- Required form completed with bid, policy available now on IndyGo website.
- Expect to provide copies of certifications and documentation of required capacity.

Procurement

Bid Notifications will be distributed by IndyGo.

Vendor Registration:

- <https://www.indygo.net/procurement/vendor-registration/>

Purple Line Newsletter:

- <https://www.indygo.net/purple-line/>

Document Distribution:

- All Bidders are to sign the required NDA (Non-Disclosure Agreement). IndyGo will accept only bids with a signed NDA.
- The NDA signature will be the vehicle for Contractor access of the SSI (Sensitive Security Information).

What Comes Next?



Release of Bid Packages A and B:

April 2021 *or after*

Subcontractor Outreach Meetings:

February 25 and March 2, 2021

Presentation to ICR/ISA Members:

March 25, 2021

Pre-Bid Meeting:

April 2021 *or after*

In advance of the release, please join our [LinkedIn Purple Line Group](#).



How We Are Helping to Connect Businesses

Connect with Chelci:

- <https://www.linkedin.com/in/chelci-hunter-a7303b139/>
 - Request to join the IndyGo Purple Line Group!



Connect with our Supplier Diversity Consultant, Aleta Mungal:

- <https://www.linkedin.com/in/aletamungal/>

About the Purple Line Group:

- The formation of this group is an act of community stewardship to assist bidders and subcontractors connect during the pandemic.

How to Work the LinkedIn Group

- Read the profiles of others in the group to see how you might team together.
- Post useful content.
- Be respectful of other's time and privacy.
- Do not post your intellectual property.
- When you find a "good fit," request meetings via email, LinkedIn messages, or phone calls.
- **Determine partnerships and/or teams in advance of bid release.**
- A meeting with a DBE or Prime Contractor does not constitute a commitment.



A Word About LinkedIn

Using the Group to Connect with Others:

1. Make sure your LinkedIn profile is up to date and lists your certifications and qualifications, if applicable.
2. Make sure others can connect with you:
 - Check your settings.
 - Under “Who can reach you?” Click on, “Everyone on LinkedIn.”

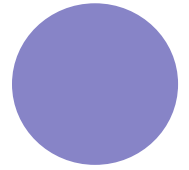



From Red to Purple to Blue!

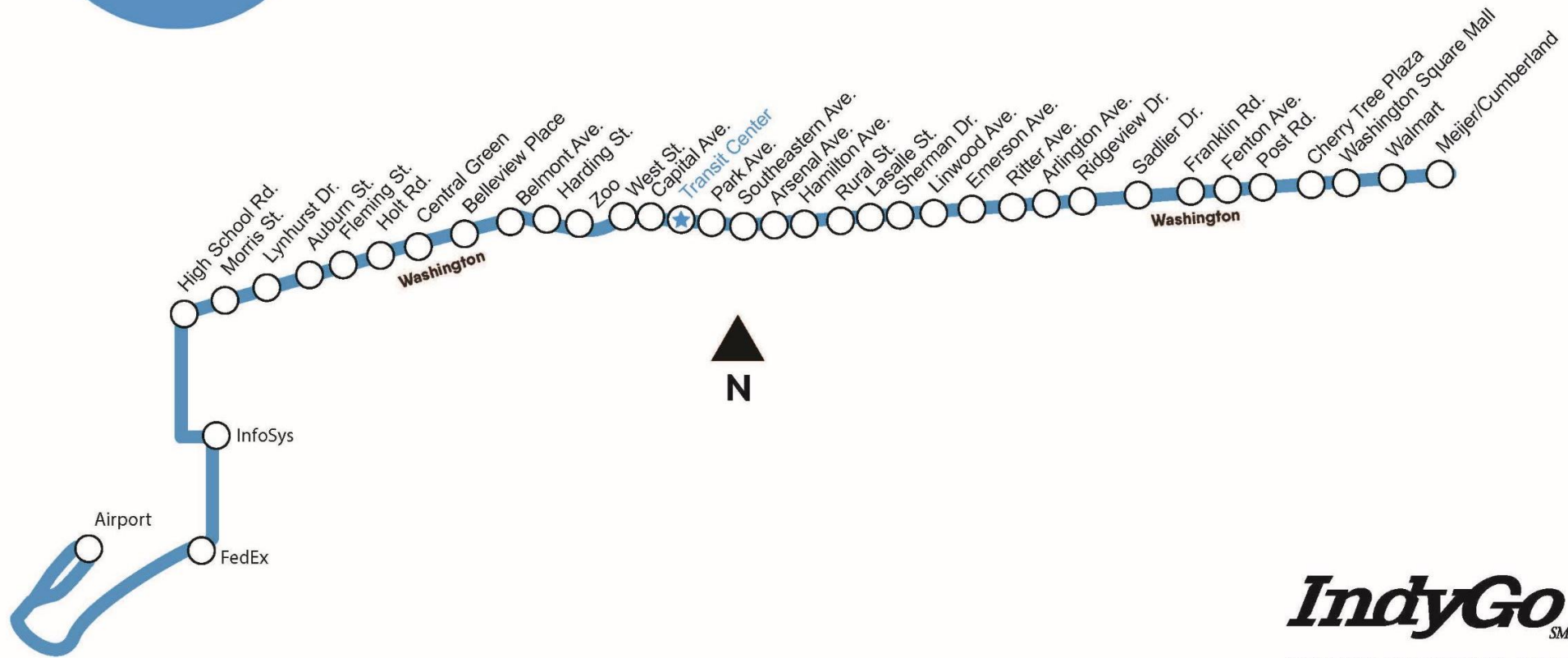
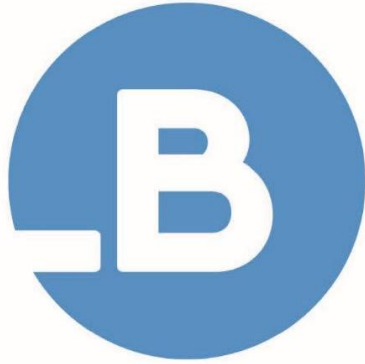

IndyGoSM
WWW.INDYGO.NET



- CONNECTING CUMBERLAND AND THE AIRPORT
- 24 MILES LONG
- 39 PROPOSED STATIONS

IndyGoSM

65
NEW OR UPGRADED
TRAFFIC SIGNALS

499
NEW OR REPLACED
ADA CURB RAMPS

17.5
MILES OF STREET
RESURFACING

55,350 LINEAR FEET OF
NEW OR REPLACED SIDEWALK

12 STATIONS WITH BIKE PARKING,
CAPACITY OF 8 BIKES PER STATION

17,250 LINEAR FEET OF NEW
OR REFRESHED CROSSWALKS

11,500 LINEAR FEET
OF MULTI-USE PATH

2023

CONSTRUCTION

2025

REVENUE SERVICE

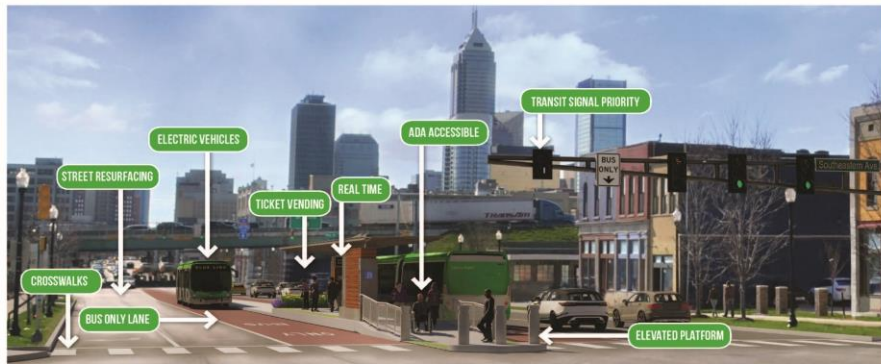

Fast Facts About the Blue Line

- Construction start date: 2023 (estimate)
- Stations: Level boarding
- Station Spacing: ½ – 1 mile
- Distance: 24 miles
- Street Resurfacing: 17.5 miles
- Plus:
 - 65 new or upgraded traffic signals
 - 499 new or replaced ADA ramps
 - And more!

Contact Information

Chelci Hunter: chunter@indygo.net

Dave Adamson: dadamson@indygo.net

Supplier Diversity Dept.: SupplierDiversity@indygo.net

Procurement Dept.: Procurement@indygo.net

Bid Opportunities: www.indygo.net/procurement/bid-opportunities

Upcoming Projects: www.indygo.net/procurement/upcoming-solicitations

Vendor Registration: www.indygo.net/procurement/vendor-registration/



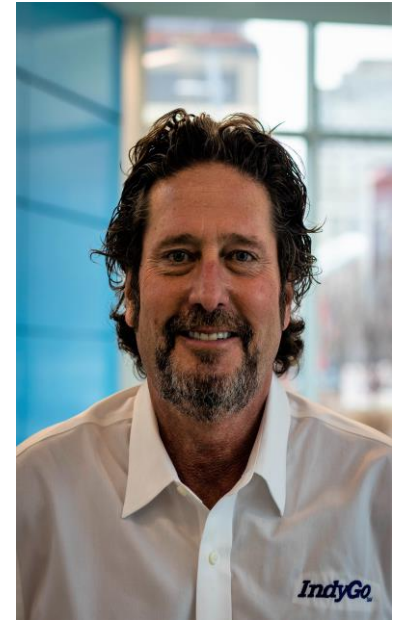

Questions & Answers

*IndyGo*SM



Thank you!